



25,862 SF Office Space

698 Cessna St, Bartow, FL 33830



**Bartow Municipal Airport
& Industrial Park**

Kristina Garcia

Bartow Municipal Airport & Industrial Park
5993 Airport Blvd, Bartow, FL 33830-0663
kristina@bartow-airport.com
(863) 533-1195

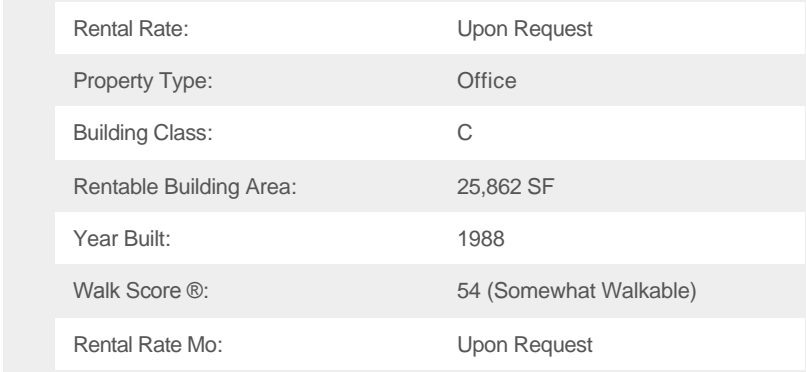

Upon Request

The office building has multiple entrances, seven restrooms, a mix of private offices with partitioned offices, and a large paved parking area. The building can be utilized by a single tenant or can be converted for multiple tenant use. The utilities (water, electric, sewer) are provided by the City of Bartow and the Airport provides security services for it's tenants after-hours and on weekends.

- On US-HWY 17 near SR-60 & US-HWY 98
- Large Paved Parking Area
- Intermodal Park
- Carpet Interior
- Private, Open and Partitioned Office Space

For more information visit:
<https://www.loopnet.com/Listing/698-Cessna-St-Bartow-FL/12629408/>

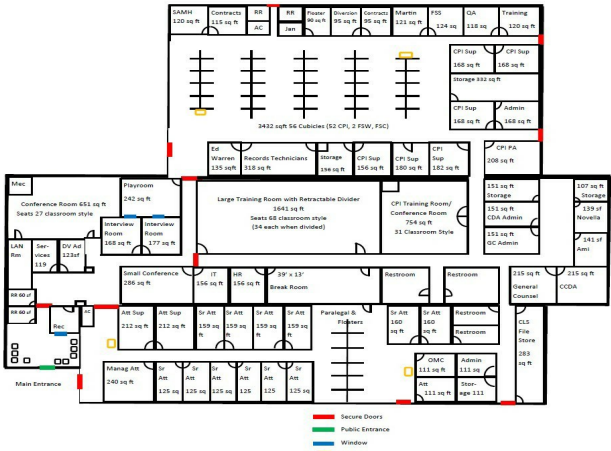

Single Floor

Space Available	25,862 SF
Rental Rate	Upon Request
Date Available	Now
Service Type	Negotiable
Space Type	Relet
Space Use	Office
Lease Term	1 - 5 Years



698 Cessna St, Bartow, FL 33830

Vacancy is within the Bartow Executive Airport's Industrial Park. Other listings available within the same area.

Property Photos

